

## Route Map

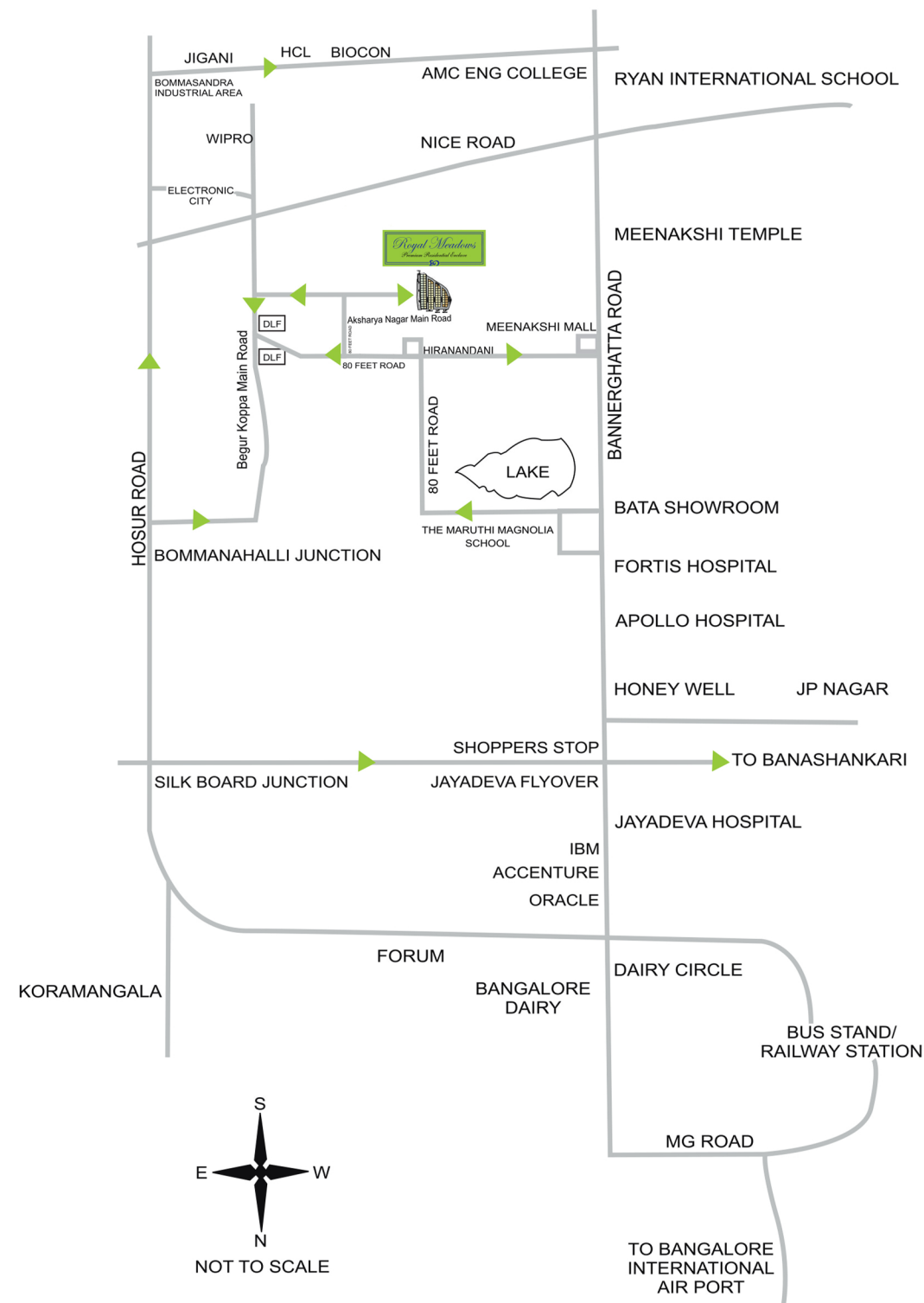

This brochure is purely conceptual. The Promoters, Developers and Architects may add, delete or alter any specifications mentioned herein, this will not have any legal binding on the Developer

**APPROVED BY ALL LEADING BANKS**



# 9/2-2, 1st Floor, Purushotham Layout, SBI Road, (Behind India Garage, St.Marks Road) Bangalore - 560 001  
Tel : 91 - 80 - 2558 9966 / 77 91 - 80 - 2555 9090 91 - 80 - 2555 9191 Mob : 91 - 98442 43077 / 91 - 98869 10013  
Email : [info@rsdevelopers.com](mailto:info@rsdevelopers.com) [www.rsdevelopers.in](http://www.rsdevelopers.in)

*Royal Meadows*

*Premium Residential Enclave*



Adjoining B.T.M Layout

*An Opportunity To Be A Chosen Few...*

**RS Developers**



Club House



Ground Floor Plan



First Floor Plan



Terrace Floor Plan

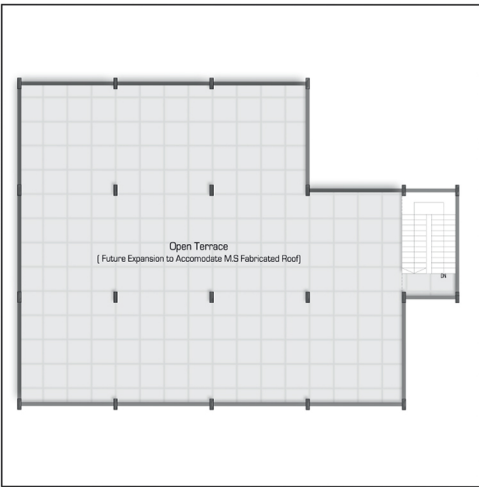

- Club house
- Indoor Games Area, TT Room, Chess, Dance / Aerobics Room, Gym, Yoga Room, Billiards Room & Departmental store

**Location:**  
It is located just 2KM from BTM Layout

- Facilities:**
- Pre-laid underground water and sanitary connection
  - 24 hours security
  - Asphalted roads
  - All round compound wall
  - Ready laid underground cable for electrical connection



Royal Meadows is a BBMP Approved 'A' Khatha development project by RS DEVELOPERS, striking a balance between rustic beauty and modern conveniences

Sprawling over 4 acres, Royal Meadows is an eco-friendly project, conserving trees, harvesting water, with large, well- maintained green areas, along with modern conveniences.

Royal Meadows consists of 75 plots of varied sizes to suit different tastes, with residential areas. Well-planned infrastructure, effortlessly incorporates all the utilities and facilities required for a contemporary lifestyle amongst the beauty of nature to give you the convenience and comfort as you long for. It makes perfect sense for those who want to get away from the hustle and bustle of the city and for those who want to make a sound investment and happy living.